



MARQUETTE PROPERTIES, INC.

Peter Fleming

Office: 815-941-0207

Cell: 773-882-6286

Email: pflaming52@yahoo.com

Michael Fleming

Office: 815-941-0207

Cell: 815-347-5151

Email: tuaminc@yahoo.com

FOR LEASE: 3727 N. Division St. Morris, IL.

Great Access to I-80

- Space:** 38,600 total square feet
- Location:** Rt. 47 just north of I-80 interchange
3727 N. Division St. Morris IL.
- Ideal For:** Great Site for light manufacturing/warehouse/trucking/industrial uses
- Lease Rate:** \$4.50 PSF, \$0.75 CAM PSF, plus utilities
- Ceiling Height:** 17'
- Access:** 2- NEW Loading docks and NEW 14' overhead door



519 Franklin St. Suite 102

Morris, IL 60450

www.MARQUETTEPROPERTIES.com



MARQUETTE PROPERTIES, INC.

Peter Fleming
Office: 815-941-0207
Cell: 773-882-6286
Email: pflaming52@yahoo.com

Michael Fleming
Office: 815-941-0207
Cell: 815-347-5151
Email: tuaminc@yahoo.com



519 Franklin St. Suite 102
Morris, IL 60450
www.MARQUETTEPROPERTIES.com

BUILDING EXHIBIT

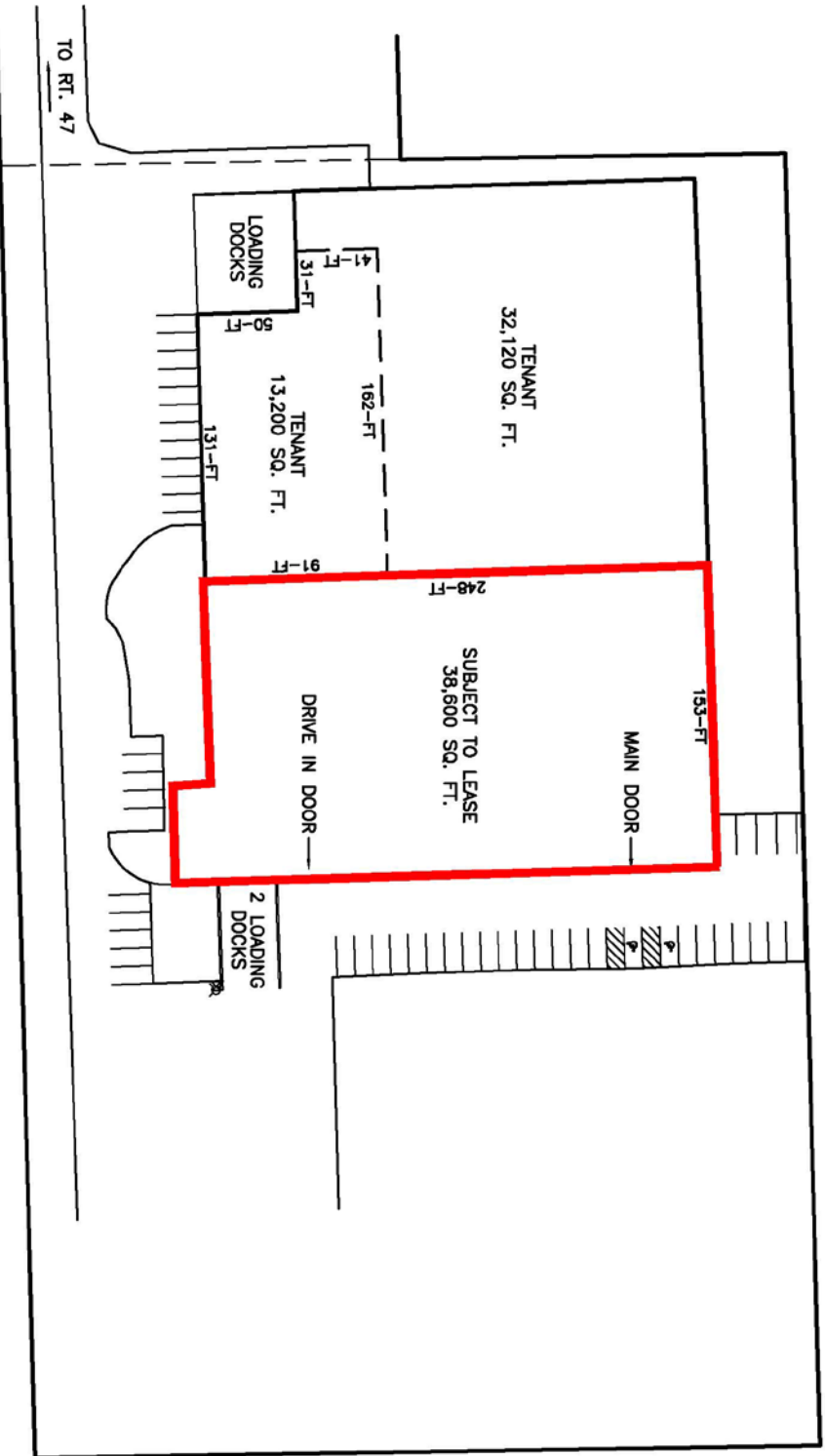

SCALE 1" = 60'



GEOTECH INC.
CONSULTING ENGINEERS - LAND SURVEYORS

1207 CEDARWOOD DRIVE CREST HILL, ILLINOIS 60403 815/730-1010

PROJECT: PAPESH AIRPORT PROPERTIES FIELD BOOK #:

DRAWN BY: CP DATE: 9/21/15 SCALE: 1"=60' JOB NO. 18214

COMPARE THIS PLAT WITH YOUR RECORDS AND IMMEDIATELY REPORT ANY DISCREPANCIES